

New premium product by Peštan

WALL drain



Premium WALL drain

Technology

PEŠTAN presents you Confluo brand with its sophisticated solutions that meet the needs of many designers and architects. New CONFLUO drain unites several modern solutions and represents a complete solution for water drainage in the modern bathroom. It is produced with one, two or three inputs and output with adjustable angle. Siphon design is created with high functionality, in order to prevent the entrance of sewer gases, even in cases when the water completely evaporates in the drain.

Design

PEŠTAN WALL drain is designed by highest standards. There are two different metal grid. Simple metal grid and for high demanded buyers 24K gold plated grid. The drain is made for easy use and simple installation.

Installation

Steps and guides for installation

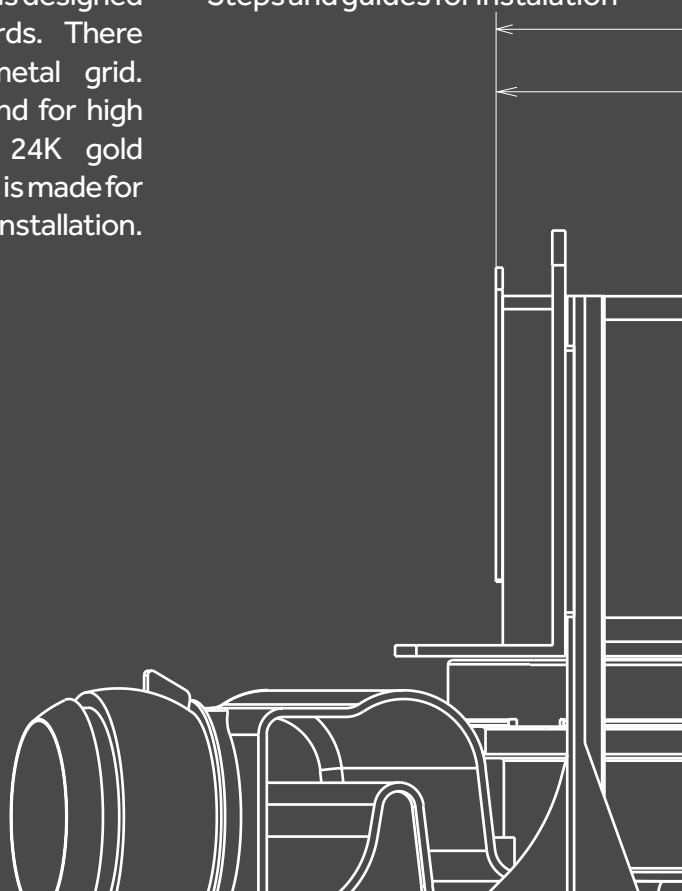

Technical specifications and measurements

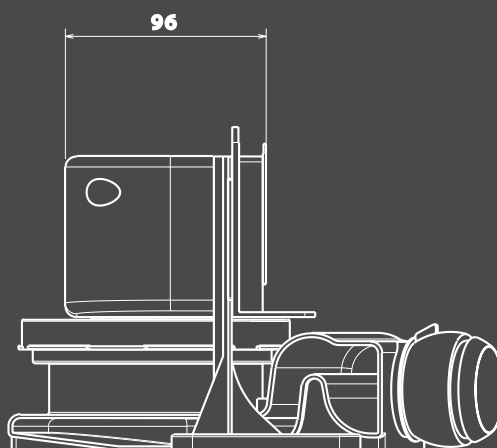
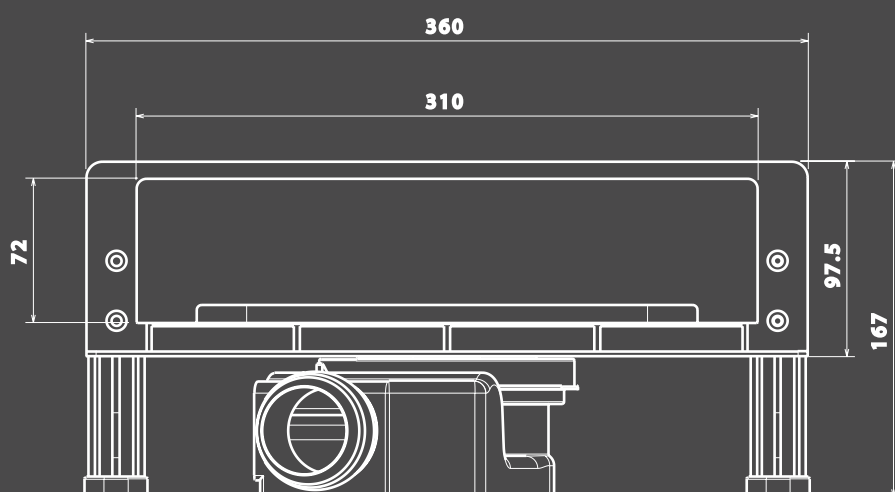



Adjustable by height.



The S base can be adjusted by rotation.



Drain output can be fine adjusted if necessary.



Ideal for renovation projects

The Scada wall drain stand out thanks to its flexible installation options. The low Installation height of just 83mm up to the upper edge of the tile makes it ideal for renovation projects.



Premium WALL drain

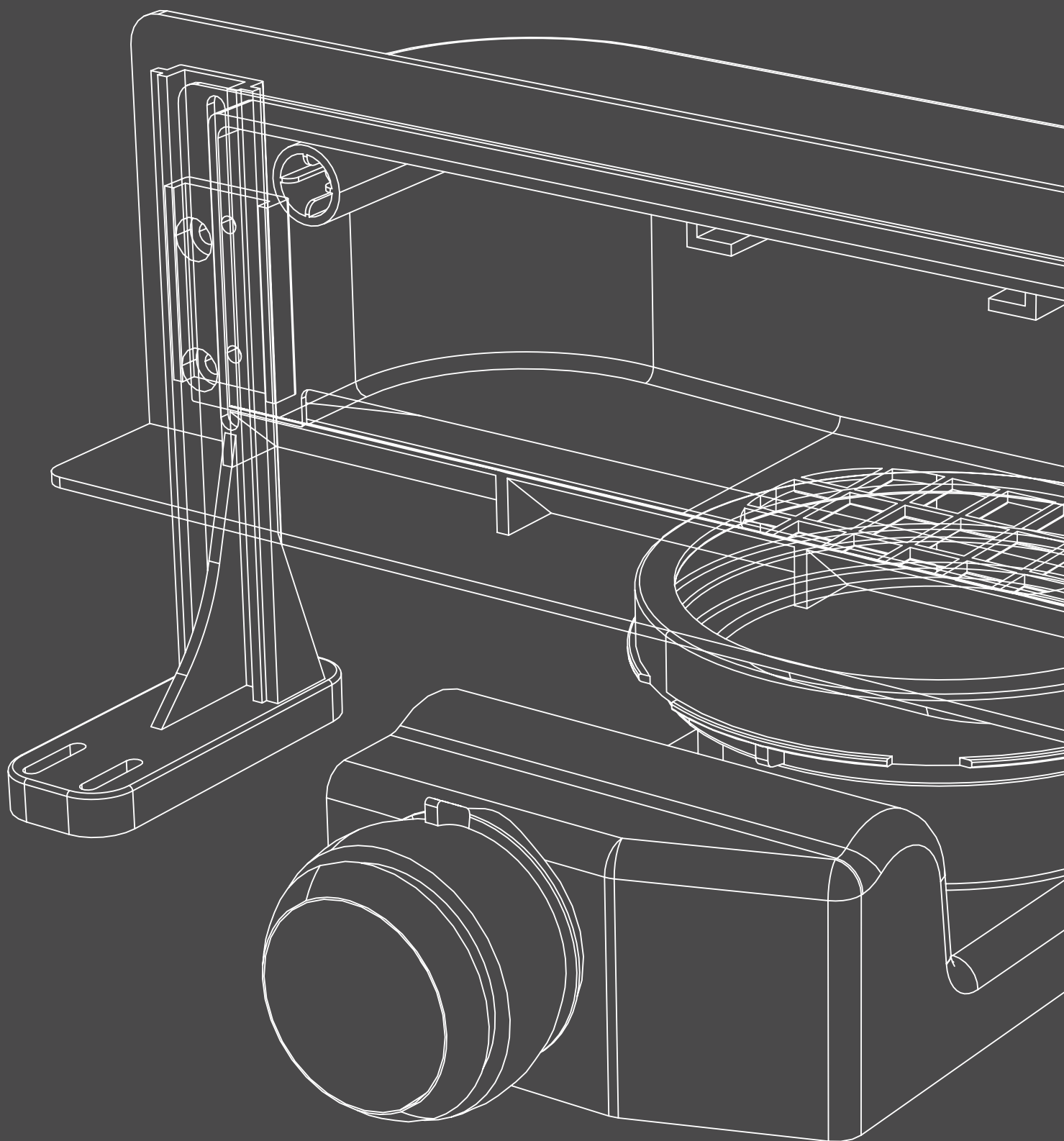

Design and parts

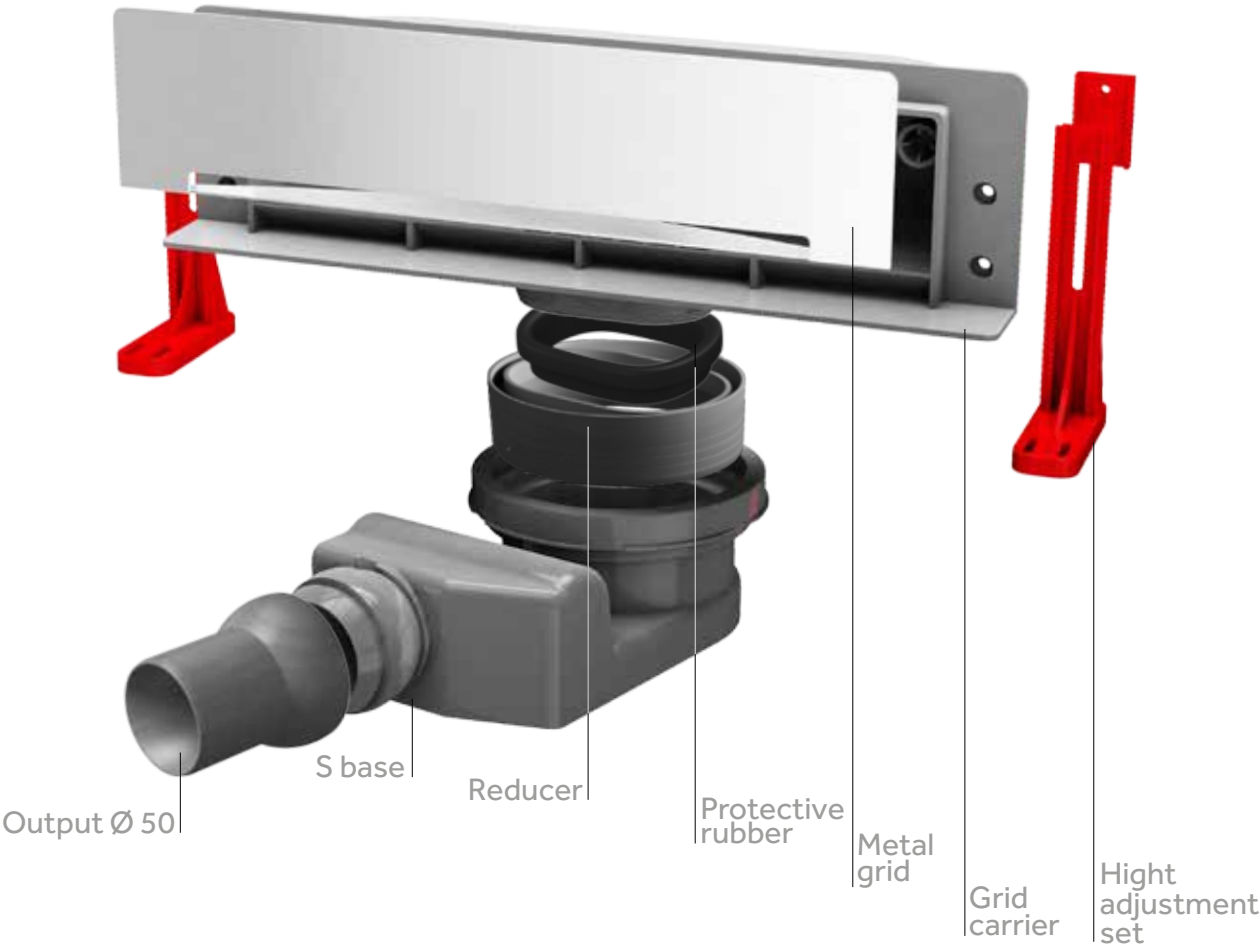

SIDE VIEW



TOP VIEW



BACK VIEW



FRONT VIEW



Installation

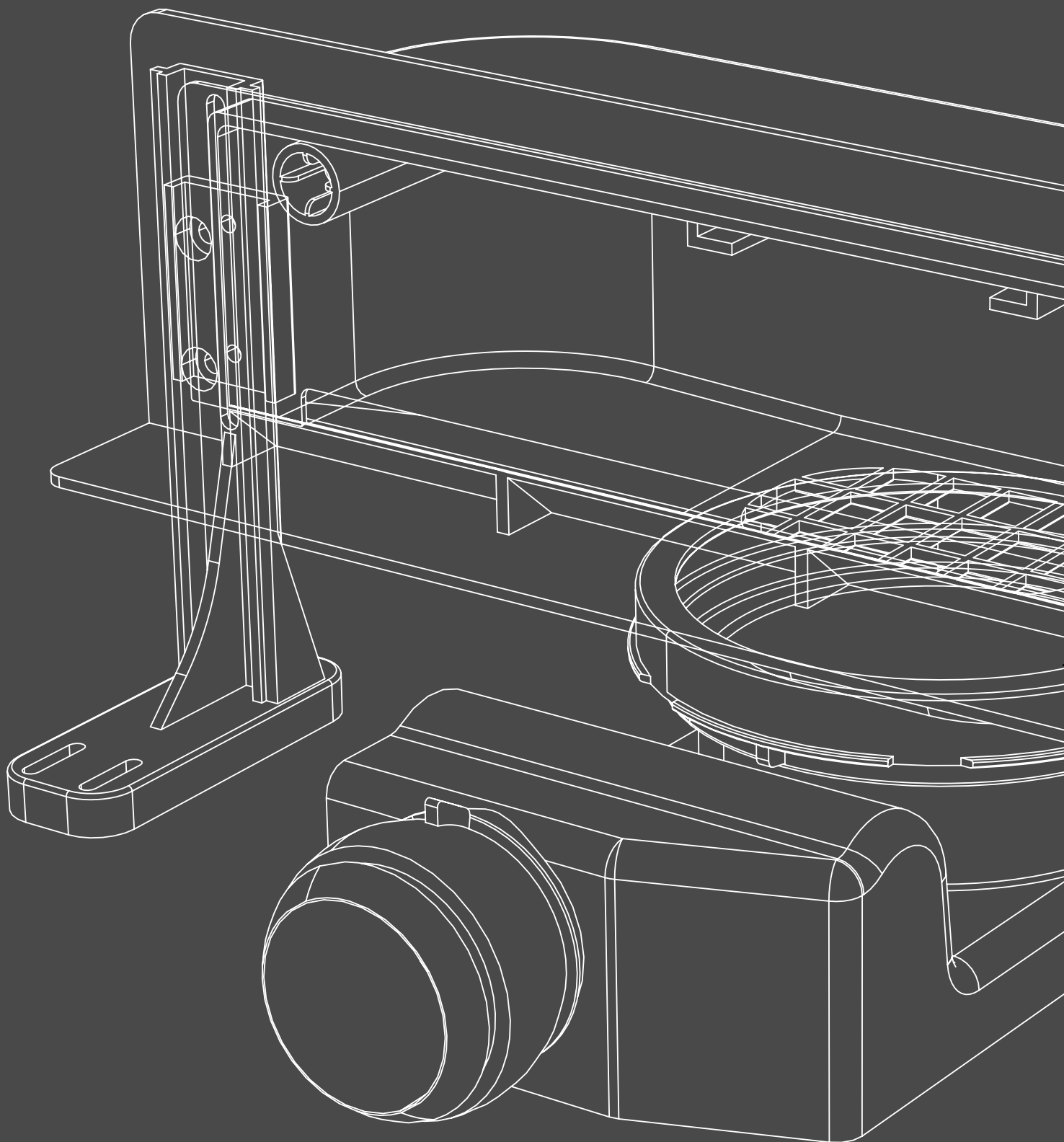

Wall drain installation with board

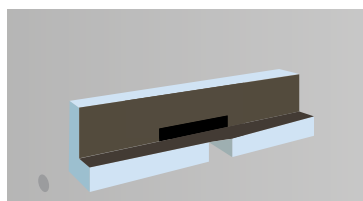
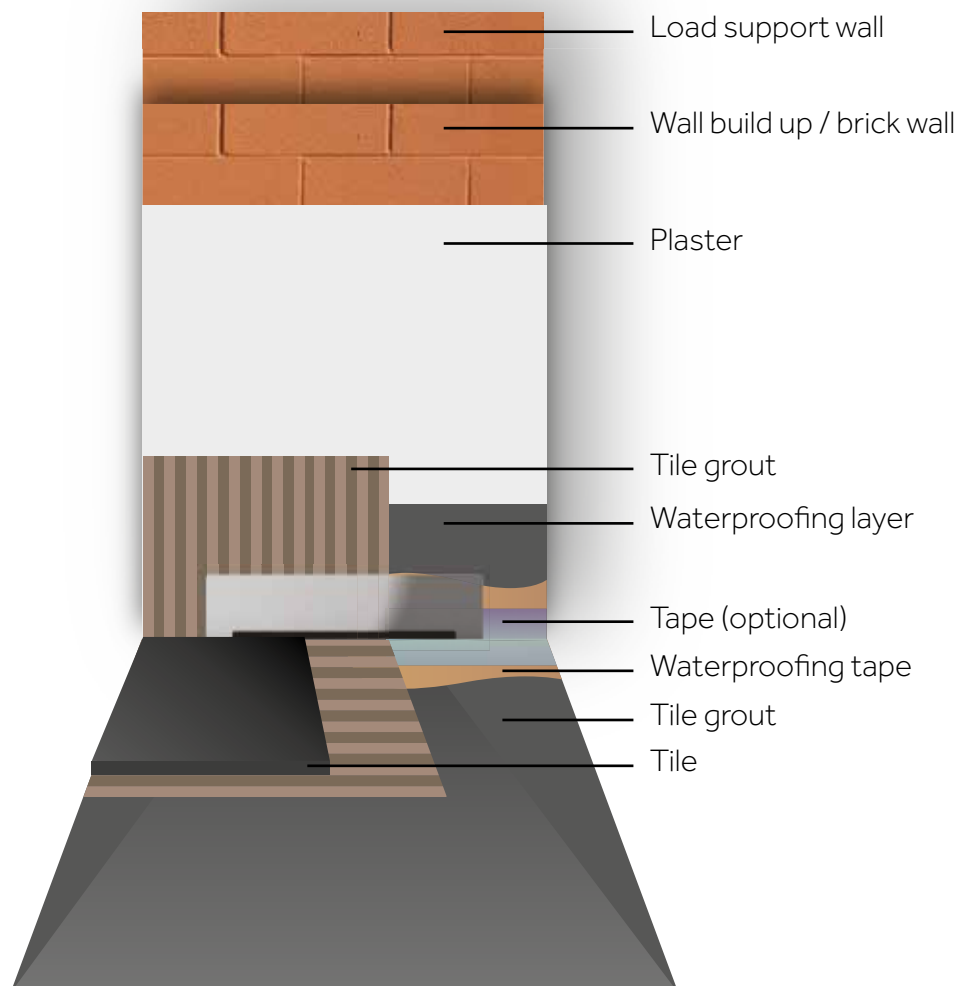

installation board with factory installed and sealed wall drain. Optional installation board with integrated slope which replaces insulation layer, sealing layer and screed.

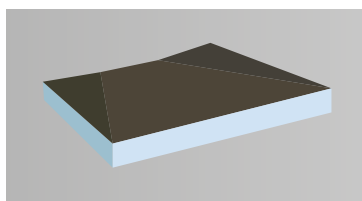

Quick and easy installation with the integrated sloped shower board.

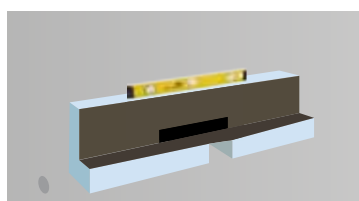

Easy installation and leveling of board.

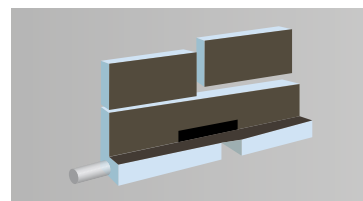

Designed for easy brick and mortar wall installation.

Wall drain installation dry wall construction

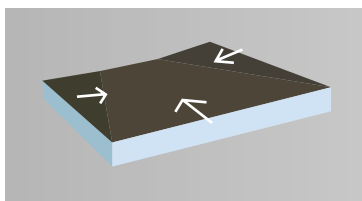
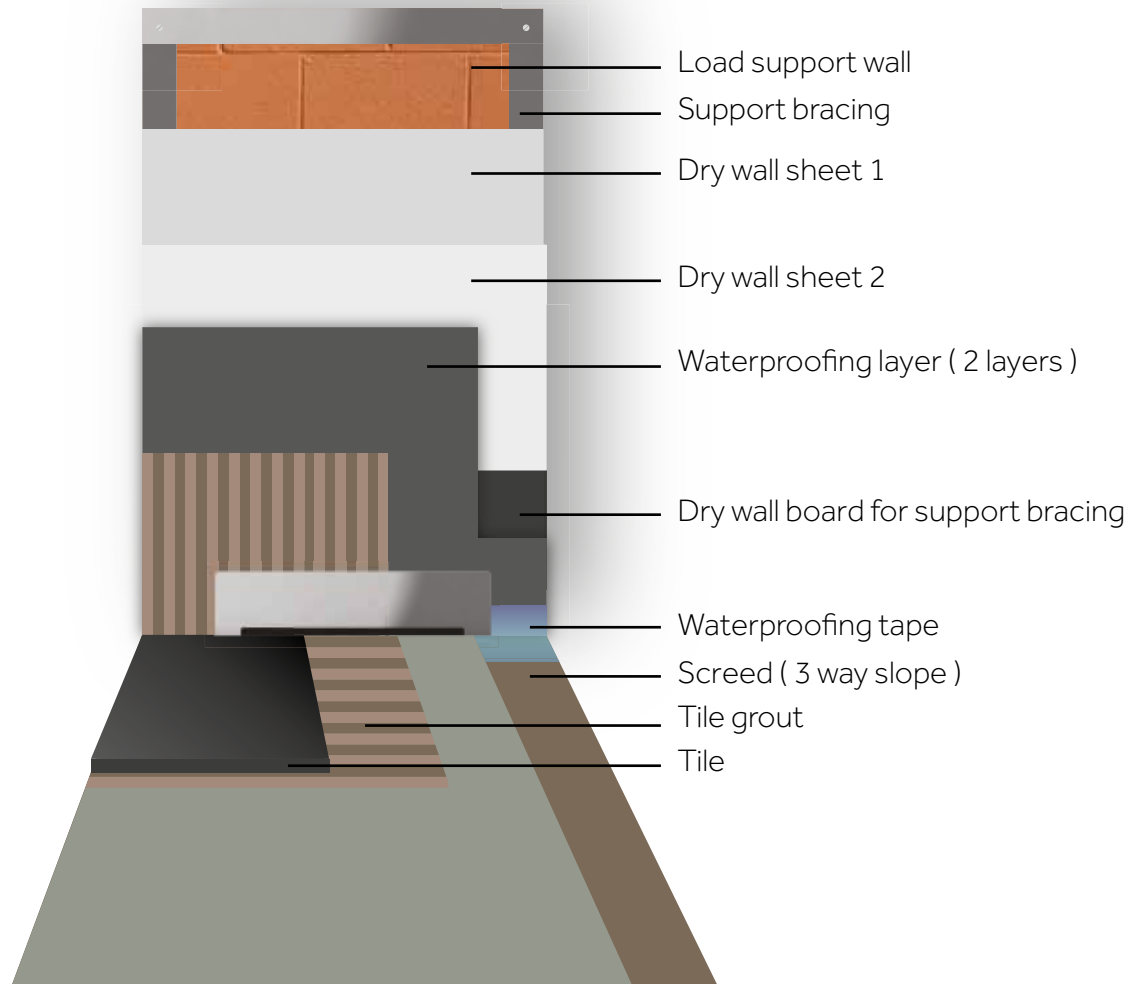

3 way slope is required for proper drainage.



Every drain has integrated support system for vertical adjustment.



Drain installation is independent from all surrounding walls or supports. Dry wall boards which are installed separately are convenient for connection to surrounding walls.

Wall drain installation brick wall constructions

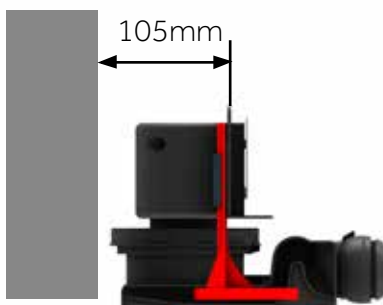
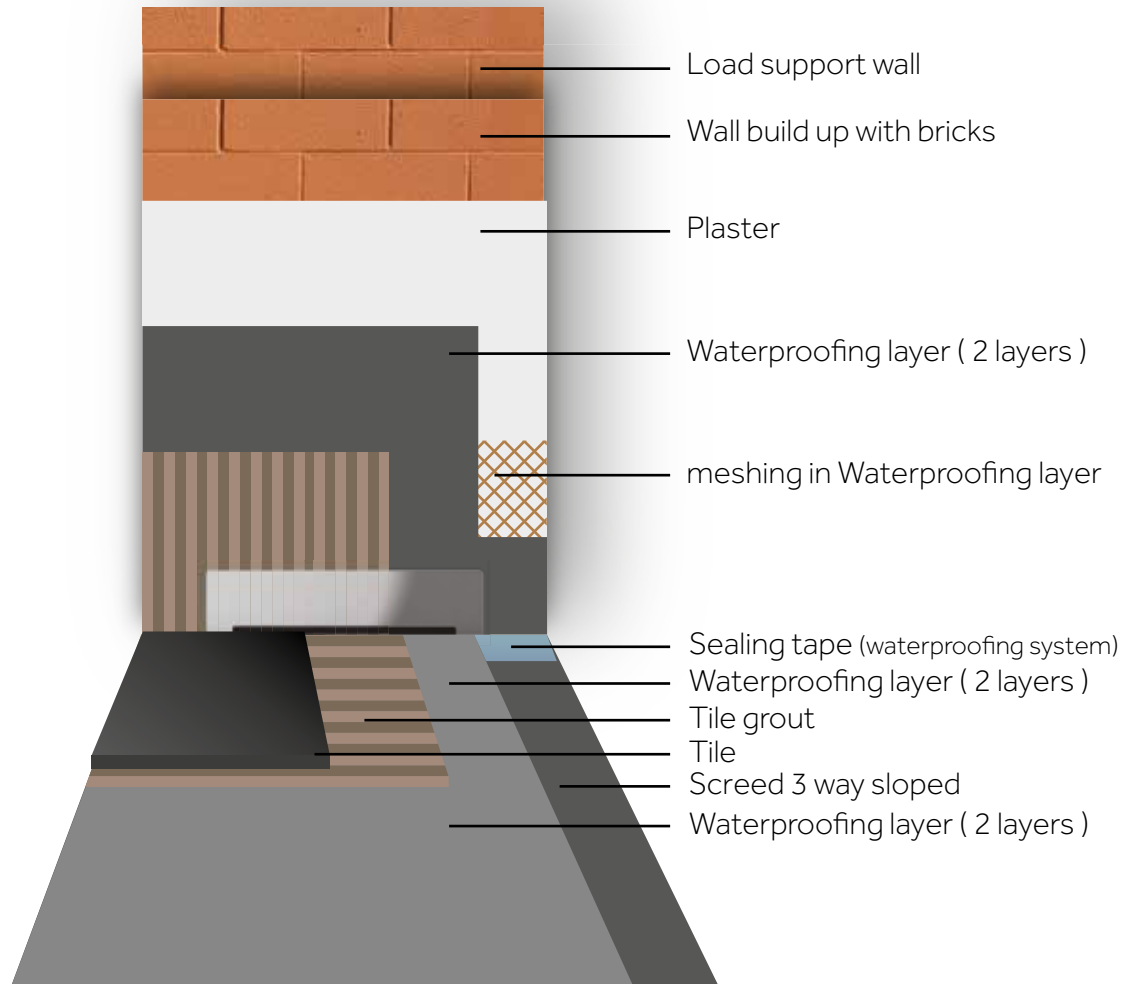

Minimal installation only
105 mm from base to
finished tile floor.

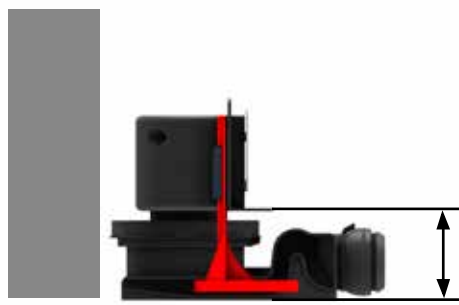

Easy installation of
wall drain and vertically
adjustable up to 83 mm

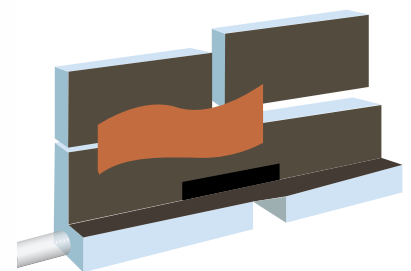

Waterproofing
connection with
integrated flange.

